

Patent pending Level Dry System

# **INSTALLATION INSTRUCTIONS AND SAFE PLAY GUIDELINES**



**WARNING:** Keep parts away from children and do not allow play on the playset until fully assembled. To reduce risk of serious injury or death, read and follow these instructions. Adult assembly required. For residential home use only. Not intended for commercial or public use

To assure a safe structure and play experience read the ***Outdoor Home Playground Safety Handbook*** by the CPSC. Go to - <https://www.cpsc.gov/s3fs-public/324.pdf>

**Tools required: Hammer, drill, and 1/8" diameter drill bit**

Select a location for your swing set that is level, dry, free of obstructions and surface hazards. Provide a safety zone at least 6 feet of distance from sides of the set and at least 16 feet at the front and back to provide a safety zone for swinging. See Guidelines and Warnings on next page and refer to Outdoor Home Playground Safety Handbook.

Once you are confident of a properly leveled location, with safety zone, place set as desired on the leveling blocks. Stakes sold separately are highly recommended to better secure the set. Drive stakes through holes in blocks into the ground and fasten to sides of posts or legs using screws. Drilling 1/8" pilot holes into the wood will ease driving screws.

Leveling blocks are reversible for use with sets with angled legs or vertical posts. (See diagrams)

## **Vertical post installation**

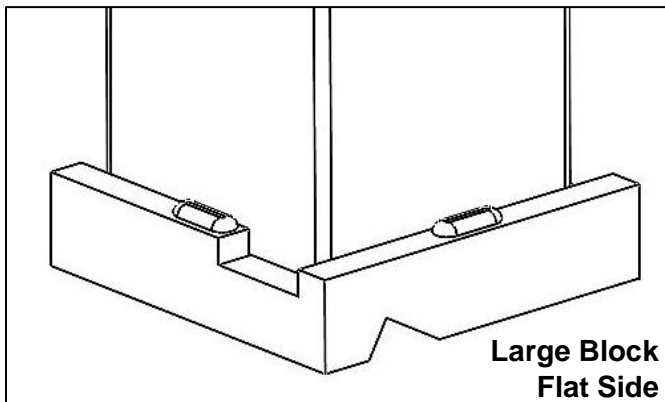

**Large Block  
Flat Side**

When installing on corner post - Most manufacturers provide rebar stakes. Please install rebar stakes as per recommendation on your swing set manual.

## **Angled post installation**

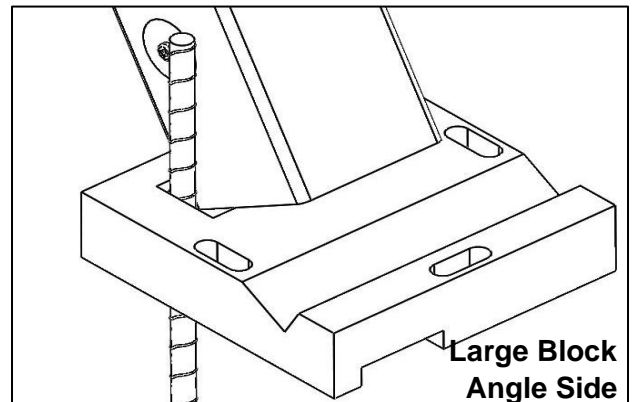

**Large Block  
Angle Side**

When installing on Beam legs use angle side – To better secure set, use Rebar stakes shown in Diagram with Screw (purchased separately)

When installing on rock wall or access ladder rails use Small Block angle side up.

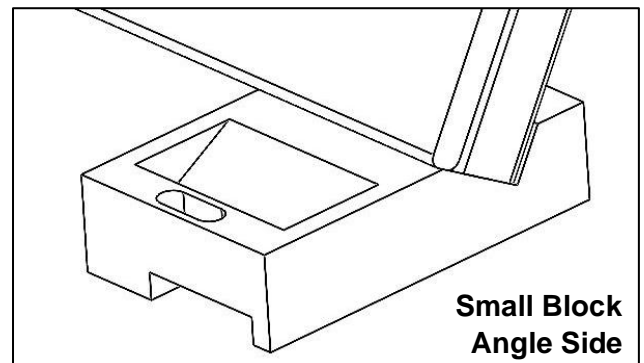

**Small Block  
Angle Side**

To help level your swing set, you may purchase and use additional blocks. The interlocking nubs will align blocks for stacking. Caution – Do not exceed two blocks per stack.

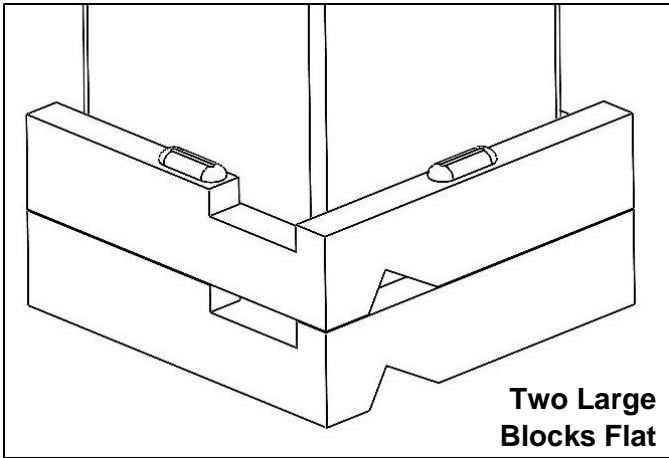

**Two Large Blocks Flat**

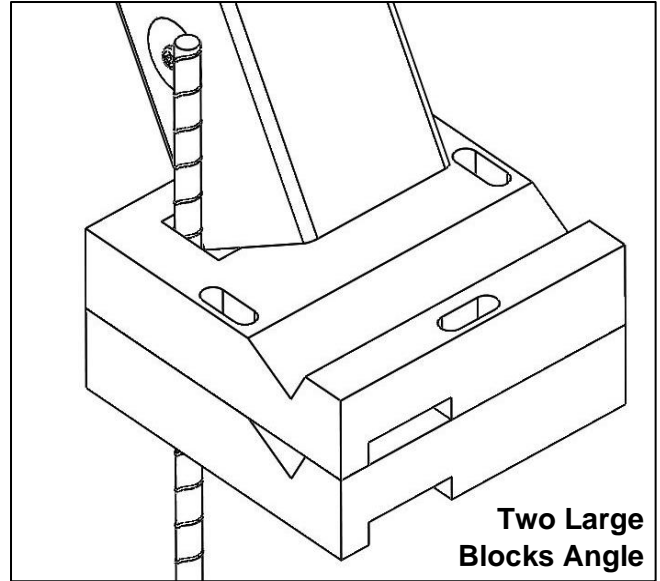

**Two Large Blocks Angle**

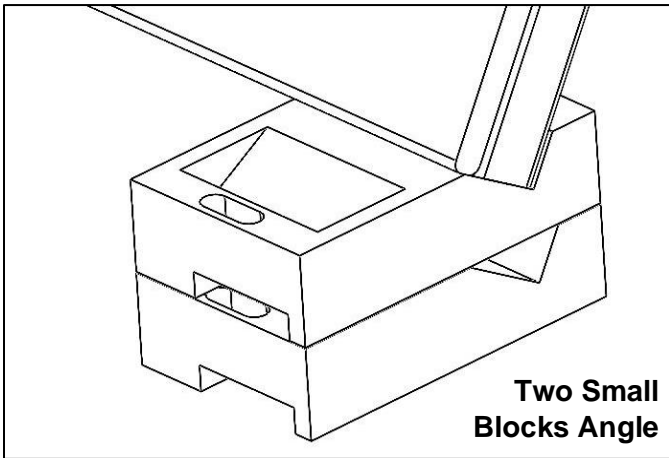

**Two Small Blocks Angle**

Small Blocks can be stacked with angle side up for access ladders, rock walls and angle supports attached to vertical posts. Stack only two high if placing blocks under entire unit.

For more information, please go to Website "How to use" Tab on home page at <https://leveldry.com/gallery/>

## **Guidelines and Warnings to follow for backyard play equipment.**

**ADULT SUPERVISION REQUIRED** - Most serious injuries and deaths on playground equipment have occurred while children were unsupervised! Read all instructions and warnings associated with your play equipment to reduce the risk of serious or fatal injury. To assure that users of all ages follow safe play instructions, provide continuous on-site adult supervision. Keep these instructions for future reference.

**SERIOUS HEAD INJURY HAZARD** - Installation of a playset over concrete, asphalt, dirt, grass, carpet, and other hard surfaces creates a risk of serious injury or death from falls to the ground. Install and maintain shock absorbing material under and around playset.

### **STRANGULATION HAZARD -**

- NEVER allow children to play with ropes, lines, leashes, or cord-like items when playing on a playset.
- NEVER allow children to wear clothing that is loose fitting, with drawstrings, cords or other elements that could catch on equipment.
- NEVER allow children to wear bike or sport helmets.

Failure to prohibit these items, even helmets with chin straps, increases the risk of serious injury and death to children from entanglement and strangulation.

**COLLISION HAZARD** - Playsets should be placed on level ground at least 6 feet from any obstruction such as buildings, fences, trees, and other obstructions. Provide an **OBSTACLE FREE SAFETY ZONE** that is free of hard objects on the surface below the playset.

For product support, please contact us at [info@leveldry.com](mailto:info@leveldry.com)  
Level Dry, PO Box 580 Martinsville, NJ 08836 *Patented pending*